

**OVERALL DEVELOPMENT DATA**

WH 1 Site Area	34,835 m <sup>2</sup>
WH 2 Site Area	31,735 m <sup>2</sup>
WH 3 Site Area	39,422 m <sup>2</sup>
WH 4 Site Area	52,951 m <sup>2</sup>
WH 5 Site Area	50,298 m <sup>2</sup>
Road Reserve Area	8,551 m <sup>2</sup>
<b>Total Site Area</b>	<b>217,792 m<sup>2</sup></b>
<b>Total Office Area</b>	<b>5,479 m<sup>2</sup></b>
<b>Total Warehouse Area</b>	<b>105,063 m<sup>2</sup></b>
<b>Total Building Area</b>	<b>110,542 m<sup>2</sup></b>

**LOT 1**

Site Area	34,835 m <sup>2</sup>
Offices	915 m <sup>2</sup>
Warehouse	18,020 m <sup>2</sup>
<b>Total GFA</b>	<b>18,935 m<sup>2</sup></b>
Site Coverage	54%
Awning	3,204 m <sup>2</sup>
Light Duty Pavement	2,600 m <sup>2</sup>
Heavy Duty Pavement	7,088 m <sup>2</sup>
Carpark Provided	73

**LOT 2**

Site Area	31,735 m <sup>2</sup>
Offices	900 m <sup>2</sup>
Dock Office	125 m <sup>2</sup>
Warehouse	16,165 m <sup>2</sup>
<b>Total GFA</b>	<b>17,190 m<sup>2</sup></b>
Site Coverage	54%
Awning	2,064 m <sup>2</sup>
Light Duty Pavement	3,534 m <sup>2</sup>
Heavy Duty Pavement	5,588 m <sup>2</sup>
Carpark Provided	106

**LOT 3**

Site Area	39,422 m <sup>2</sup>
Offices	900 m <sup>2</sup>
Dock Office	125 m <sup>2</sup>
Warehouse	20,015 m <sup>2</sup>
<b>Total GFA</b>	<b>21,040 m<sup>2</sup></b>
Site Coverage	53%
Awning	3,204 m <sup>2</sup>
Light Duty Pavement	4,479 m <sup>2</sup>
Heavy Duty Pavement	8,737 m <sup>2</sup>
Carpark Provided	137

**LOT 4**

Site Area	52,951 m <sup>2</sup>
Offices 4A	658 m <sup>2</sup>
Dock Offices (Total)	514 m <sup>2</sup>
Warehouse	29,934 m <sup>2</sup>
<b>Total GFA</b>	<b>31,106 m<sup>2</sup></b>
Site Coverage	59%
Awning	2,917 m <sup>2</sup>
Light Duty Pavement	2,437 m <sup>2</sup>
Heavy Duty Pavement	10,153 m <sup>2</sup>
Carpark Provided	114

**LOT 5**

Site Area	50,298 m <sup>2</sup>
Offices (Total)	1,500 m <sup>2</sup>
Warehouse	20,771 m <sup>2</sup>
<b>Total GFA</b>	<b>22,271 m<sup>2</sup></b>
Site Coverage	44%
Awning	3,050 m <sup>2</sup>
Light Duty Pavement	4,853 m <sup>2</sup>
Heavy Duty Pavement	7,988 m <sup>2</sup>
Carpark Provided	142

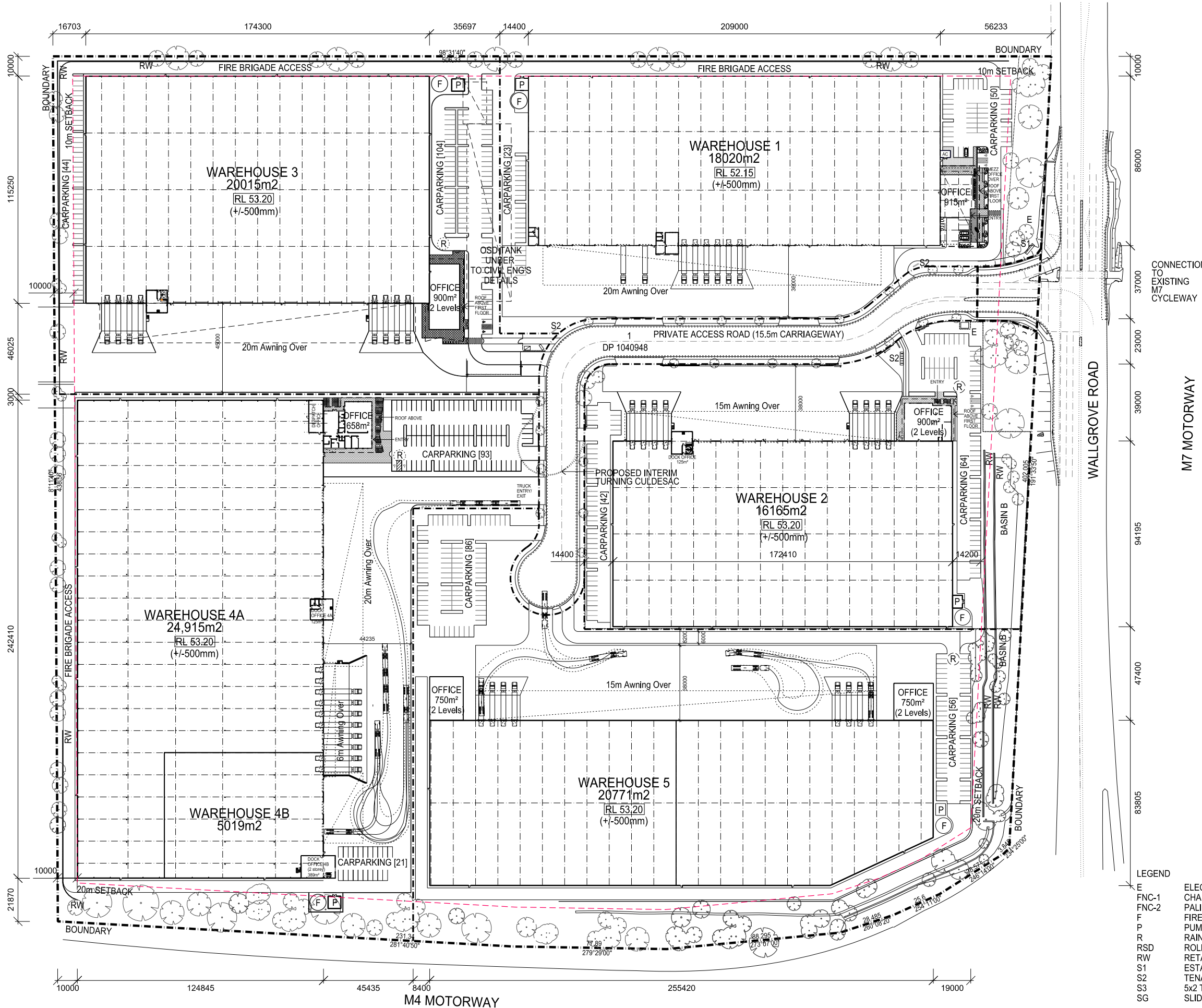

**LEGEND**

- E ELECTRICAL SUBSTATION
- FNC-1 CHAINWIRE FENCE 2.1m H
- FNC-2 PALISADE FENCING 2.1m H
- F FIRE TANK
- P PUMP ROOM
- R RAINWATER TANK
- RSD ROLLER SHUTTER DOOR
- RW RETAINING WALL
- S1 ESTATE PYLON SIGN
- S2 TENANT PYLON SIGN
- S3 5x2 TENANT IDENTIFICATION SIGN
- SG SLIDING / SWING GATE

NOTE: REFER TO CIVIL DRAWINGS FOR PAVEMENT LEVELS

